



5th/6th Gear

Installation

NOTE:

- Replace all locknuts and spring pin.
- 6-Speed type is shown.

1. Reassemble the parts following the numbered sequence.

	Bolt Size	Torque Value	
A	6 x 1.0 mm	12 N-m (1.2 kg-m, 9 lb-ft)	24

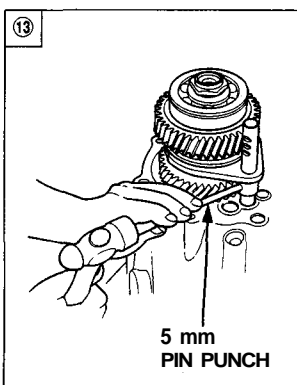
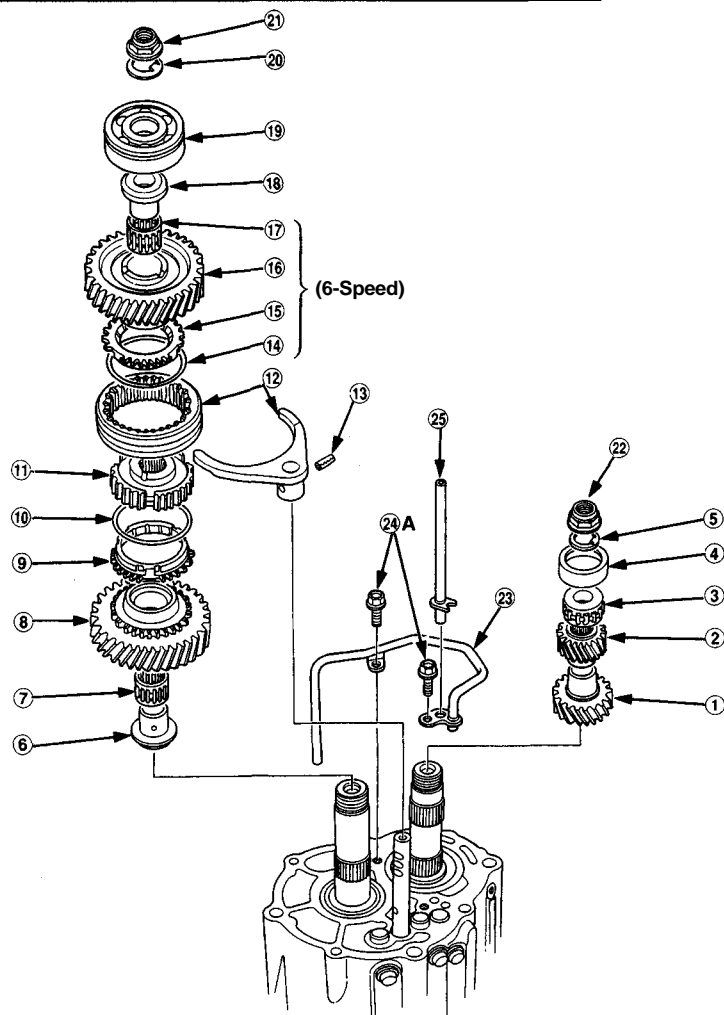

21 22

- 1. Install the special tool.

MAINSHAFT HOLDER
07924-PJ4010A

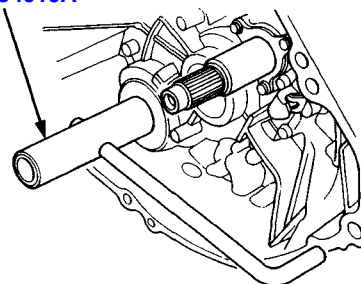

- 2. Tighten the locknut, then stake the locknut tab into the groove.

NOTE: Countershaft locknut has left-hand threads.

LOCKNUT:

MAINSHAFT:
185 → 0 → 185 N-m
(18.5 → 0 → 18.5 kg-m, 134 → 0 → 134 lb-ft)

COUNTERSHAFT:
165 → 0 → 165 N-m
(16.5 → 0 → 16.5 kg-m, 119 → 0 → 119 lb-ft)

LOCKNUT
Replace.
SPRING WASHER

